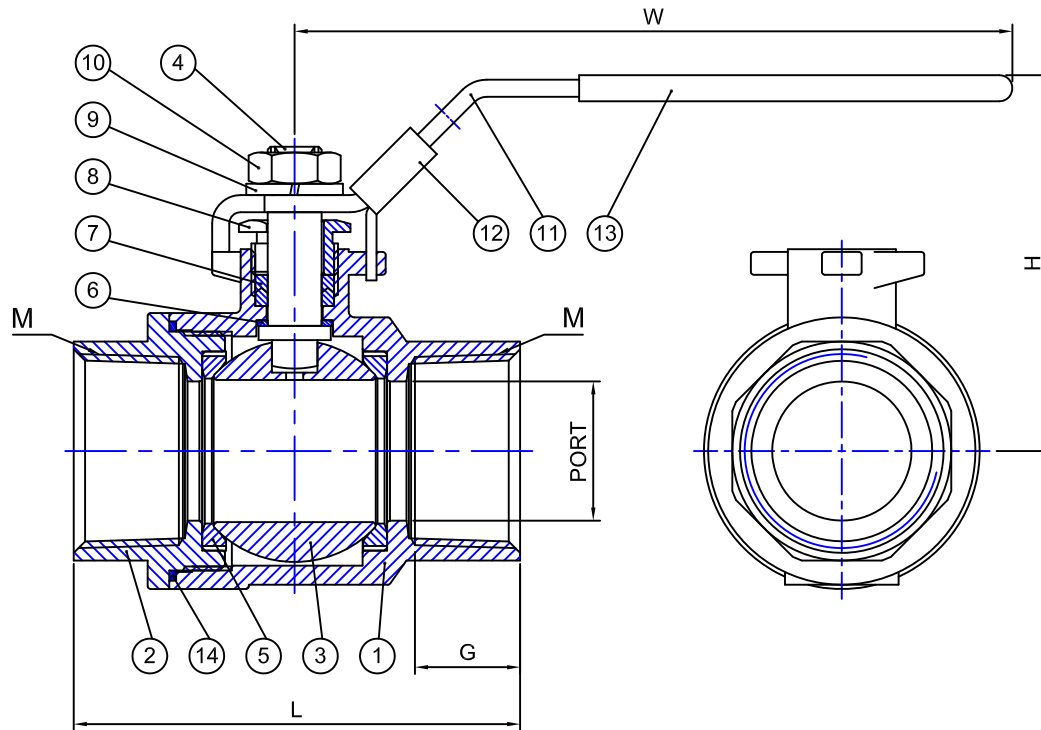
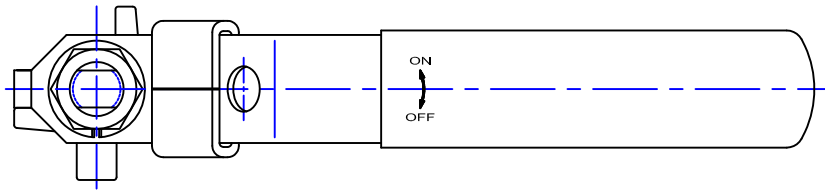

Fig No:

PB-2110C



MATERIAL LIST

NO.	PART NAME	MATERIAL		Q'TY
		STAINLESS STEEL	CARBON STEEL	
1	BODY	A351-CF8M	A216-WCB	1
2	CAP	A351-CF8M	A216-WCB	1
3	BALL	A351-CF8M		1
4	STEM	SS316		1
5	SEAT	RPTFE		2
6	THRUST WASHER	PTFE		1
7	STEM PACKING	PTFE		1SET
8	GLAND NUT	SS304		1
9	SPRING WASHER	SS304		1
10	NUT	SS304		1
11	HANDLE	SS304		1
12	LOCKING PAD	SS304		1
13	HANDLE COVER	PLASTIC		1
14	GASKET	PTFE		1

DIMENSIONS

unit:mm

SIZE	PORT	M	G	L	H	W	CV	Torque (kgf-cm)	Weight (kgs)
1/4"	12.55	NPT	11	49	43.4	82	22	30.58	0.16
3/8"	12.55	NPT	11	49	43.4	82	24	30.58	0.16
1/2"	15	NPT	13.5	58.6	47.9	82	37	61.18	0.24
3/4"	20	NPT	16	68.6	57.2	102	68	81.57	0.38
1"	25	NPT	18.5	78.5	67.3	127	109	122.35	0.64
1-1/4"	32	NPT	19	93.2	73.6	127	185	163.14	0.98
1-1/2"	38	NPT	20	103.1	84.5	162	268	203.92	1.58
2"	50	NPT	24.5	123.3	92.5	162	486	254.91	2.66

Pressure VS. Temperature Chart

